

Umístění kabelů v MO - most ev. km 157,430 (Brno-Česká Třebová)

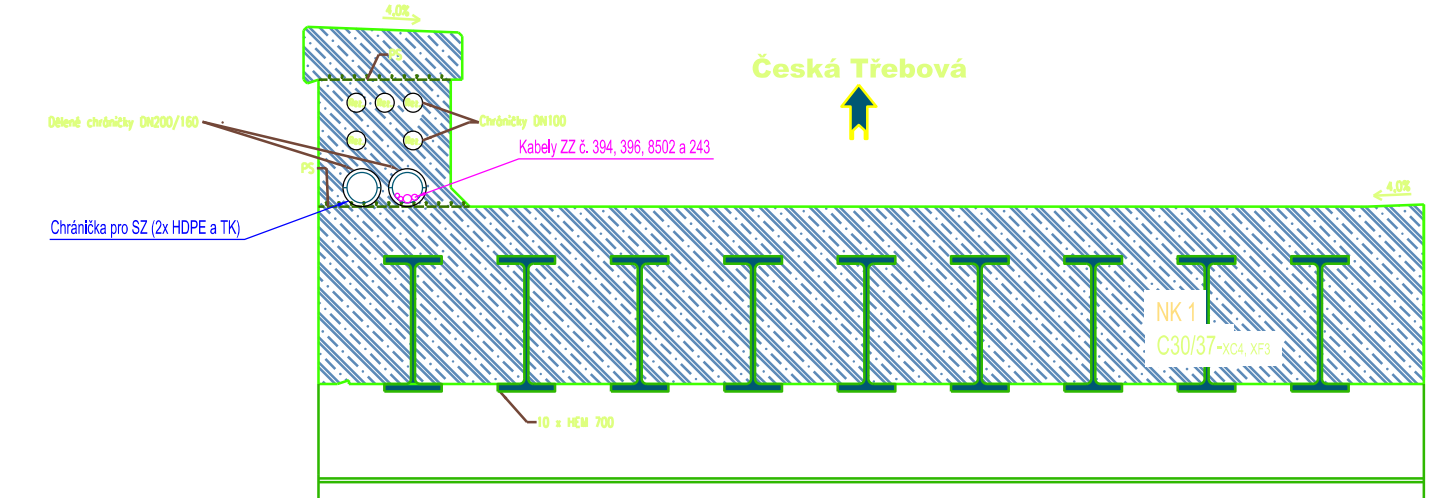

[31] 157,350 000 km

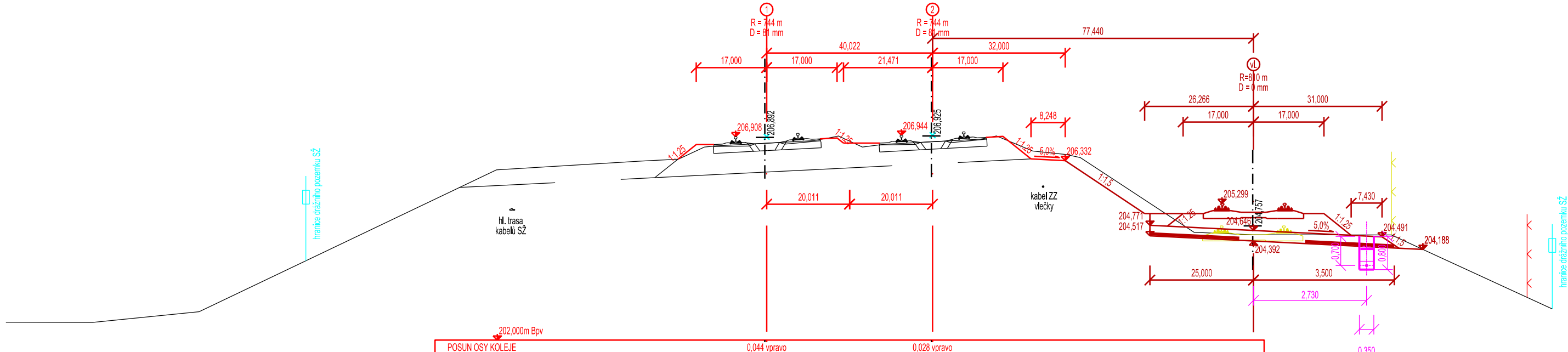

[41] 157,400 000 km

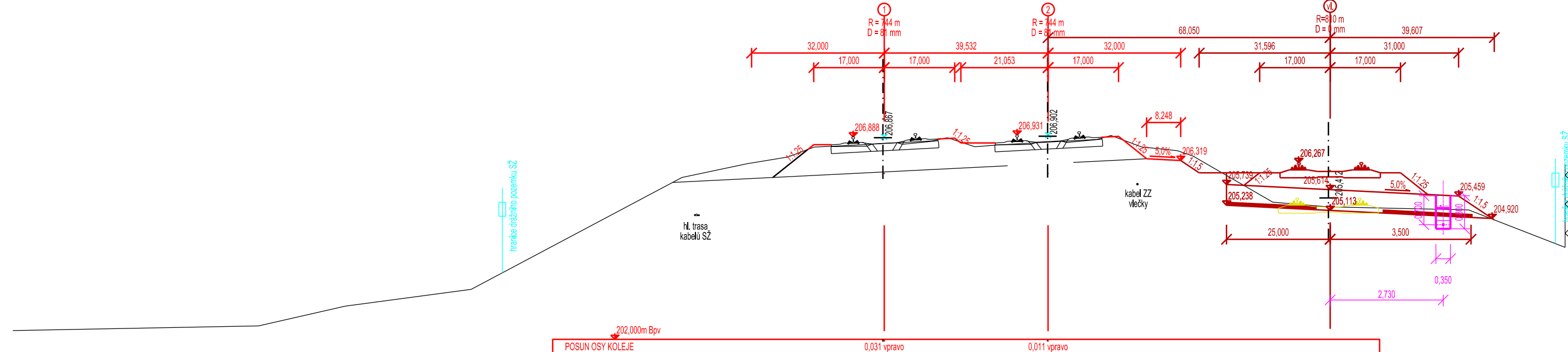

[61] 157,500 000 km

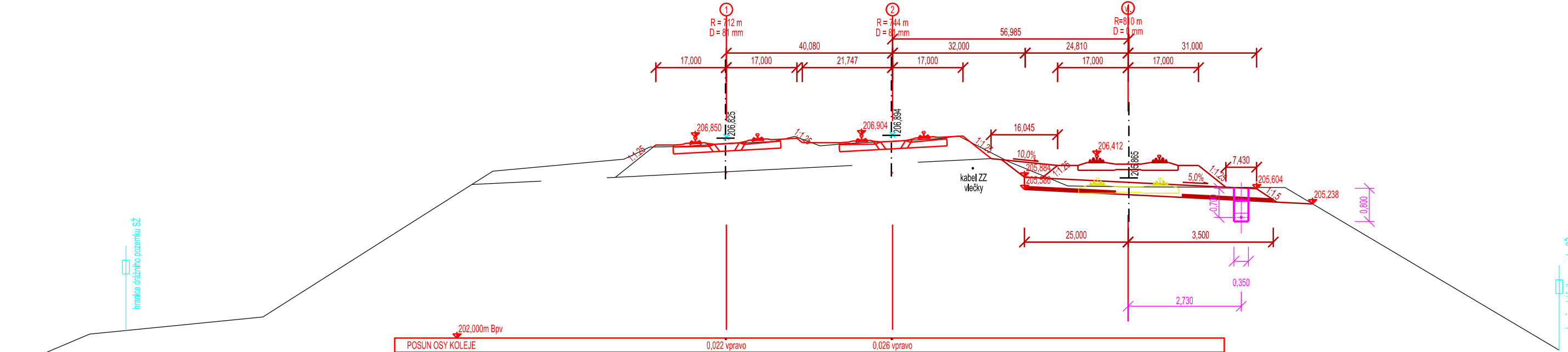

Umístění kabelů v MO - most ev. km 0,385 (Posvitavské vlečky)

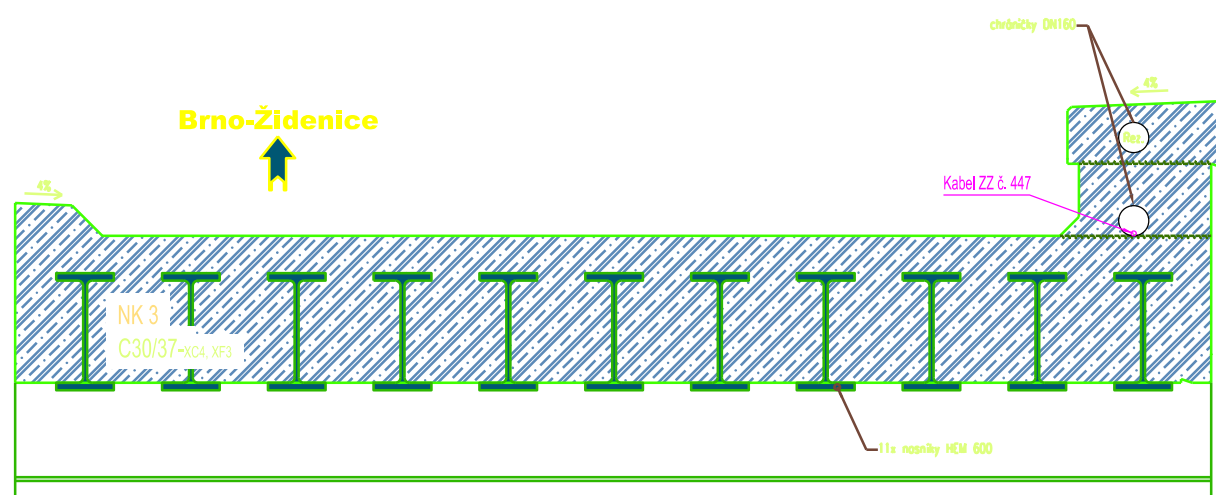

[36] 157,375 000 km

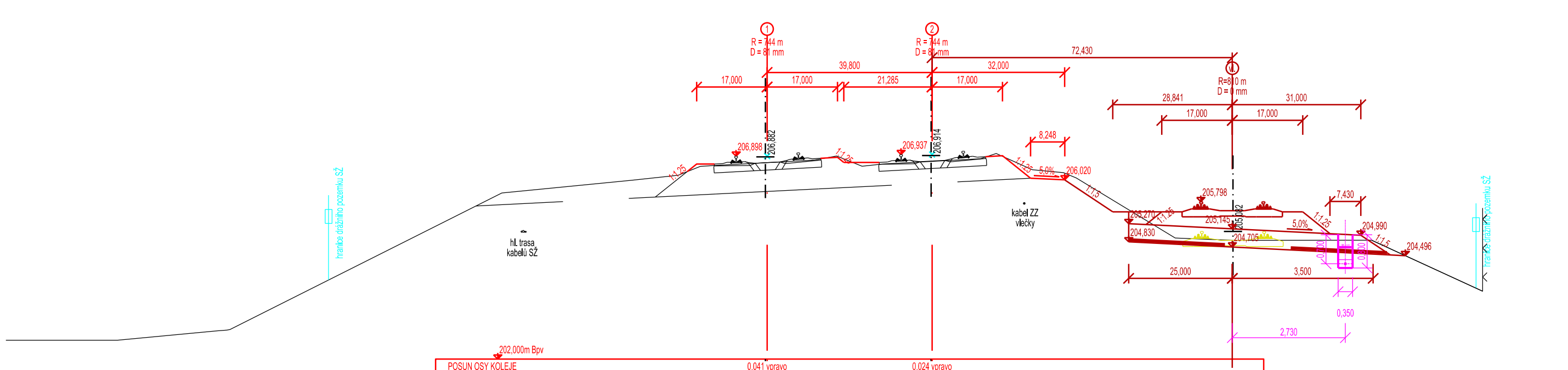

[51] 157,450 000 km

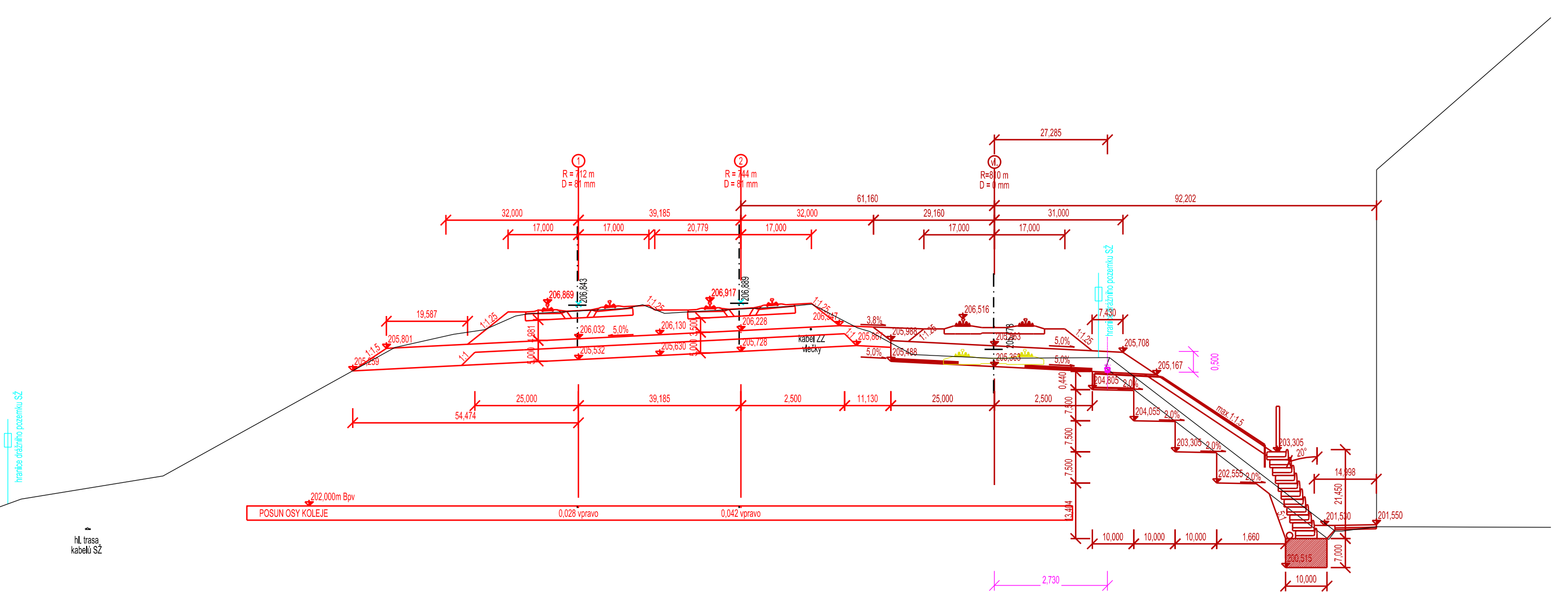

[66] 157,525 000 km

